



* Two Horse Model

STANDARD FEATURES

- 7' Wide (6'6" Inside) 7'6" Tall
- Catalyzed Polyurethane Paint / Catalyzed Two-Part Primer
- Galvanized Roof Bows / Sheeting
- Pre-Primered Tubing
- Interior / Exterior Caulking
- Kickwall Fully Enclosed w/ Slider Windows / Roof Vents, 1 per Stall
- Double Rear Door w/ 2 Slider Windows & Double Cam Latch
- Double Wall Construction w/ Wall Mats
- Camper Door w/ Slider Window & Screen
- Patriotic Vinyl or Deluxe Vinyl Detailing
- Water Tank / Boot Box & Vanity w/ Mirrored Oak Door
- Rubber Dock Bumper
- Aluminum Diamond Plate Fenders
- Spare Tire & Wheel
- 4 Wheel Electric Brakes
- Interior Lights
- Telescoping Padded Divider
- Swing-Out Saddle Rack
- Camper Door w/ Slider Window & Screen

AVAILABLE IN TWO, THREE & FOUR HORSE BUMPER PULL OR GOOSENECK MODELS

Bigger is Better...When it's not the price!

SPECIFICATIONS

2 HORSE MODEL

3 HORSE MODEL

4 HORSE MODEL

INSIDE HEIGHT.....	7'6"	7'6"	7'6"
OVERALL HEIGHT.....	8'9"	8'10"	8'10"
INSIDE WIDTH.....	6'6"	6'6"	6'6"
OVERALL WIDTH.....	8'5"	8'5"	8'5"
FLOOR HEIGHT.....	14"	15"	15"
OVERALL LENGTH.....	18'	22'	24'
TRAILER BODY LENGTH.....	14'8"	18'8"	20'8"
TANDEM AXLES.....	3500#	5200#	5200#
WHEELS.....	White Modular 5-Lug.....	White Modular 6-Lug.....	White Modular 6-Lug.....
TIRES.....	ST205/75-15/LR-C.....	ST225/75-15/LR-D.....	ST225/75-15/LR-D.....
COUPLER.....	2 5/16" Bulldog.....	2 5/16" Bulldog.....	2 5/16" Bulldog.....
BRAKES.....	10" - 4 Wheel Electric.....	12" - 4 Wheel Electric.....	12" - 4 Wheel Electric.....
EMPTY WEIGHT.....	3575#.....	4500#.....	4975#.....
HITCH WEIGHT.....	375#.....	550#.....	560#.....
PAYLOAD CAPACITY.....	3425#.....	5499#.....	5024#.....
INTERIOR LIGHTS.....	(4) 2 Dress Rooms / 2 Horse Area.....	(4) 2 Dress Rooms / 2 Horse Area.....	(4) 2 Dress Rooms / 2 Horse Area.....
PORCH LIGHT.....	(1) Tack Room.....	(1) Tack Room.....	(1) Tack Room.....
REAR LIGHT w/ SWITCH.....	(1).....	(1).....	(1).....
BRIDLE HOOKS.....	(6).....	(6).....	(6).....
CLOTHES ROD.....	(1).....	(1).....	(1).....
SADDLE RACK.....	(2) Racks / Swing Out.....	(3) Racks / Swing Out.....	(4) Stationary.....
ALUMINUM DIAMOND PLATE.....	Front & Fender.....	Front & Fender.....	Front & Fender.....
RUBBER DOCK BUMPERS.....	3".....	3".....	3".....
ROOF BOWS.....	w/ Flow Coat Galvanized.....	w/ Flow Coat Galvanized.....	w/ Flow Coat Galvanized.....
FRONT BOWS.....	Pre-Primed Steel.....	Pre-Primed Steel.....	Pre-Primed Steel.....
ELECTROGALVANIZED SHEET METAL.....	#3 Galvanized Finish.....	#3 Galvanized Finish.....	#3 Galvanized Finish.....
LOCKABLE DOUBLE REAR DOORS.....	Enclosed w/ Double Cam Latch.....	Enclosed w/ Double Cam Latch.....	Enclosed w/ Double Cam Latch.....
DOUBLE SEAL CAMPER DOOR.....	(1) w/ 10.5" x 17.5" Sliding Window.....	(1) w/ 10.5" x 17.5" Sliding Window.....	(1) w/ 10.5" x 17.5" Sliding Window.....
REAR WINDOWS.....	(2) 10.5" x 17.5" Slider.....	(2) 10.5" x 17.5" Slider.....	(2) 10.5" x 17.5" Slider.....
FEED DOOR WINDOWS.....	(2) 30" x 20" Drop.....	(3) 30" x 20" Drop.....	(4) 30" x 20" Drop.....
KICKSIDE WINDOWS.....	(2) 21" x 14" Slider.....	(3) 21" x 14" Slider.....	(4) 21" x 14" Slider.....
ROOF VENTS.....	2.....	3.....	4.....
DELUXE VINYL PACKAGE.....	Patriotic or Standard.....	Patriotic or Standard.....	Patriotic or Standard.....
VANITY SHELVING UNIT.....	Mirrored Oak Door.....	Mirrored Oak Door.....	Mirrored Oak Door.....
STOP & TAIL LIGHTING.....	(2) Each Side.....	(2) Each Side.....	(2) Each Side.....
PADDED DIVIDERS.....	(1).....	(2).....	(3).....
FLOOR MATS.....	1/2" Full.....	1/2" Full.....	1/2" Full.....
1/4" WALL MATS.....	Kickwall, Headwall, Back Door.....	Kickwall, Headwall, Back Door.....	Kickwall, Headwall, Back Door.....
SPARE TIRE.....	Standard.....	Standard.....	Standard.....
WATER TANK / BOOT BOX.....	(1)/(1).....	(1)/(1).....	(1)/(1).....

*Standard features are subject to change without notification.

TWO HORSE MODEL

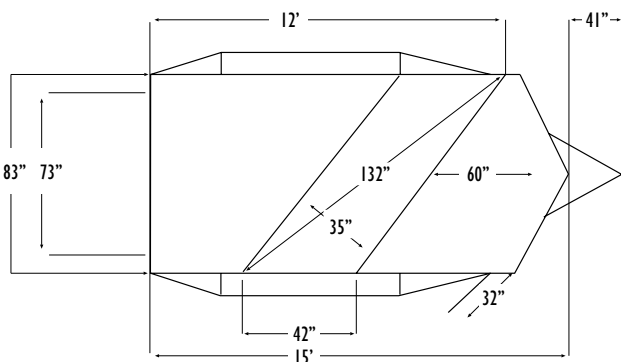

THREE HORSE MODEL

